

1 DETALLE RAMPA DE ACCESIBILIDAD

Cantidad de rampas a construir = 83 unidades

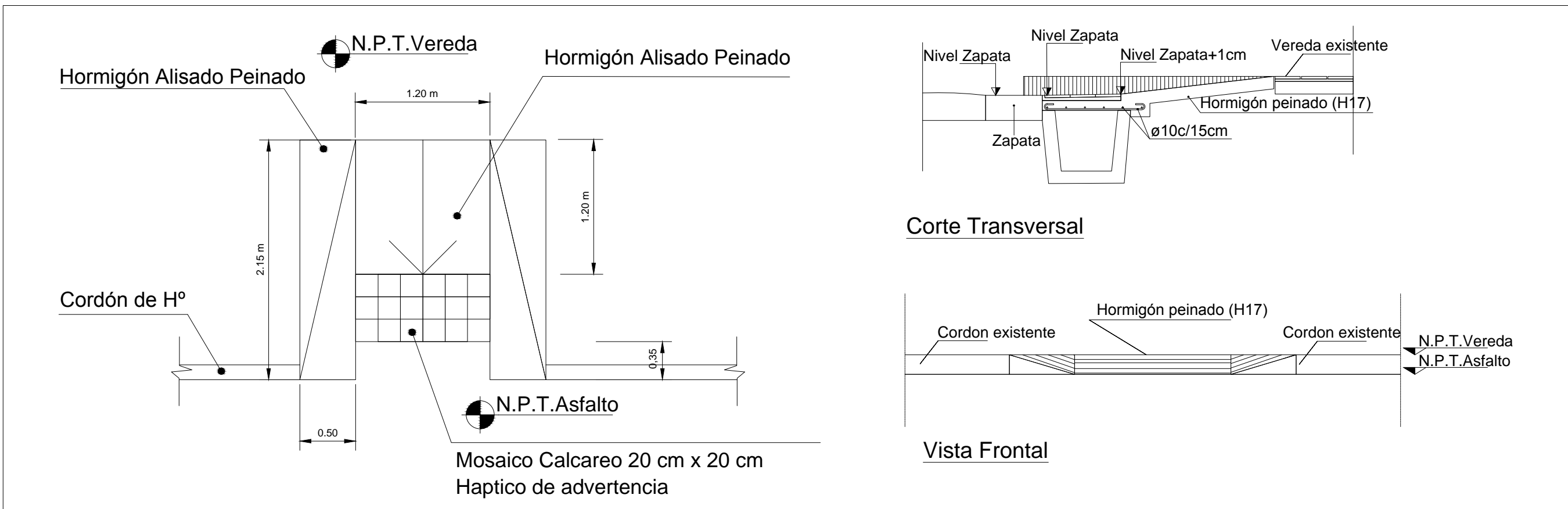

2 DETALLE TAZA ARBOLADO PUBLICO

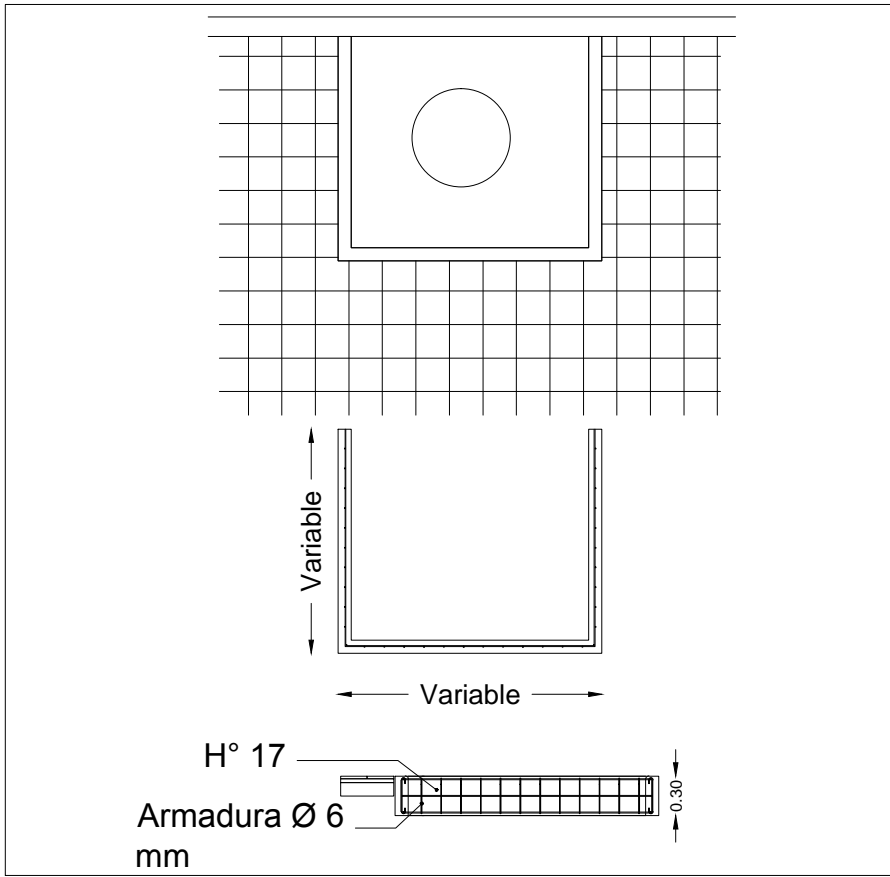

3 DETALLE VEREDA DE HORMIGÓN

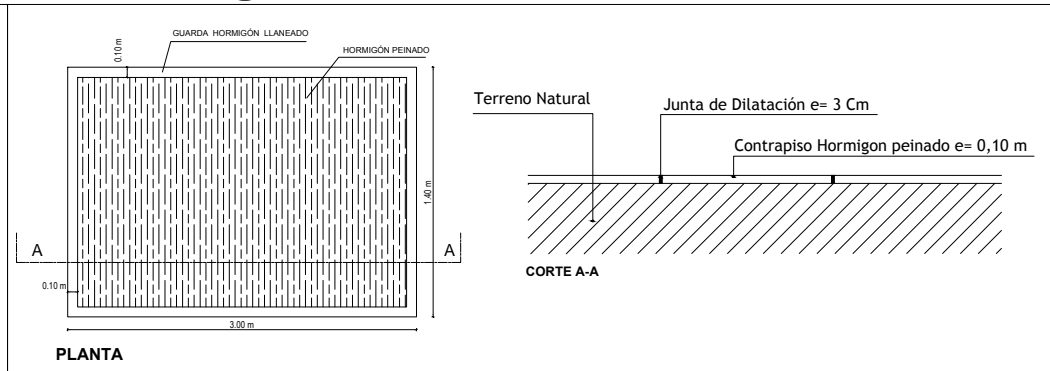

4 DETALLE VEREDA CON BALDOSA

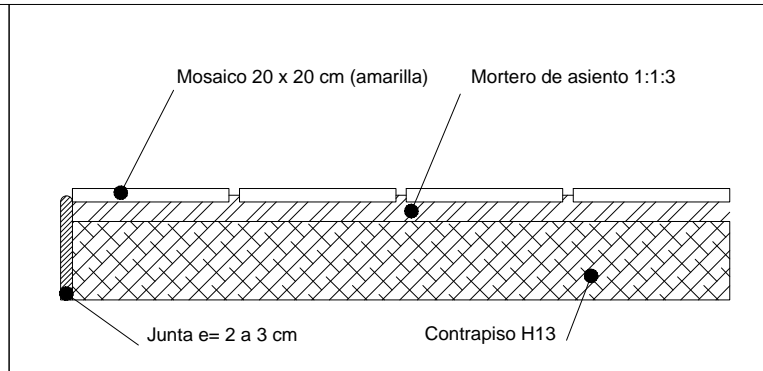

5 DETALLE REPARACIÓN DE CORDONES

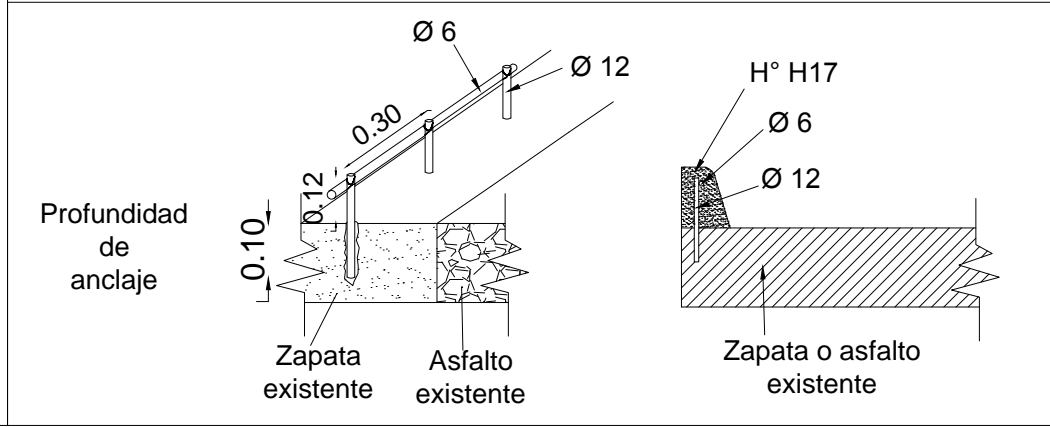

6 DETALLE REPARACIÓN DE BOULEVARD

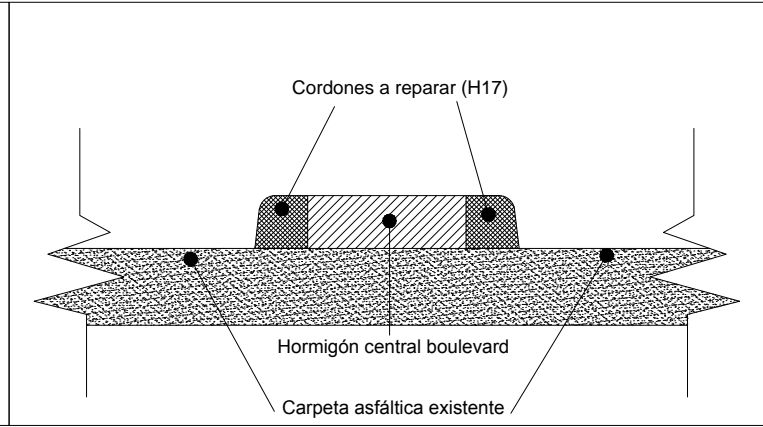

Nota: Todas las medidas deberan ser verificadas en obra